

## INSTALLATION GUIDE LOCK 0923

### Fix Controller in cabinet or compartment

Fix it with 2 screws to the designated position.

**Loose controller and cables may cause malfunctions and result in avoidable maintenance costs!**

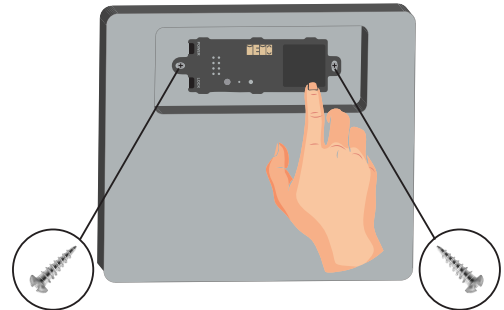

### Fix LOCK and Connect to controller

**Fix lock in cabinet but do NOT fix latch on door or drawer as long as the system function is not tested!**

Plug lock connector to available controller port and make sure it clicks in.

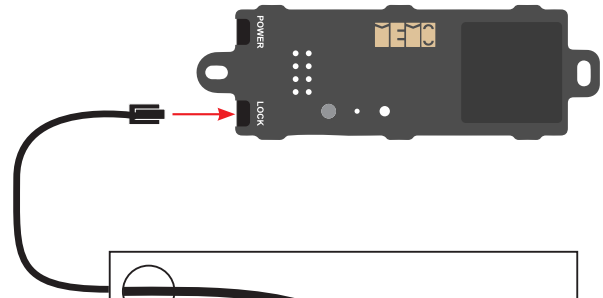

### Connect Reader Cable and fix it (optional)

AIR2MINI and AIR2FOUR models operate with external readers - connect the golden SME screw terminal to the controller by hand.

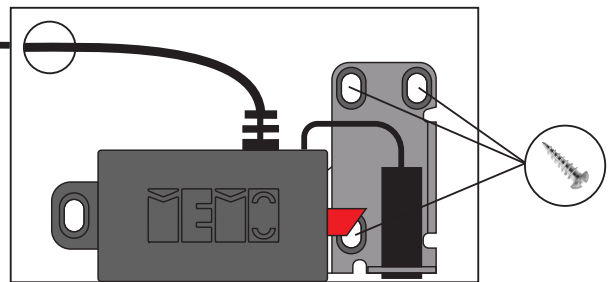

**Screw by hand, do NOT use tools! Cables must be installed securely in furniture so that moving parts as drawers, door, etc. may NOT cause damage on loose cables and devices**

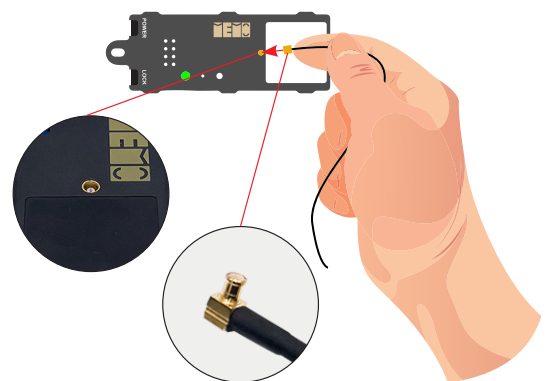

### Close all doors and drawers

In case door monitoring is active, close all doors and drawers.

**When Door monitoring is required, make sure that only ports with locks connected are active!**

### Connect Power

Plug connector of power supply to controller and wall plug.

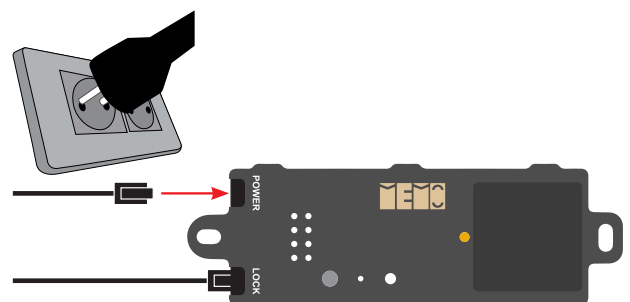

**When power is on the controller, the green LED will be ON.**

## TEST THE INSTALLATION

### Check Power & Connector

Plug **Power Connector** to available power port and make sure it clicks in. Make sure Power Supply is plugged in a wall socket.

**LED ON** - indicates the controller has power and is ready for operation. Listen for **System Ready** sound.

**LED OFF** - indicates there is no electricity at controller or a malfunction happened.

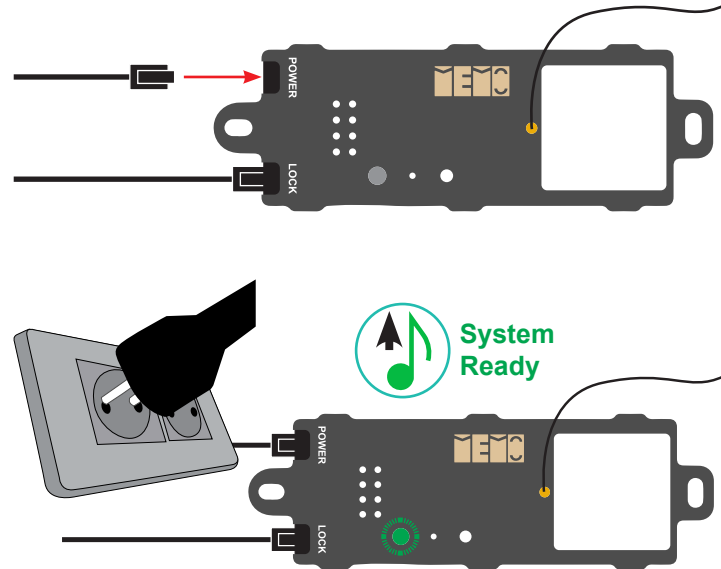

### CHECK KEY READING RANGE

Present a programmed ACCESS KEY at the batch point.

Listen for a beep sound and watch the LED on the controller or external Reader.

#### • KEY Programmed:

As soon as a beep sounds, the LED changes to a **RED** colour on the controller and LED on external reader starts blinking **GREEN**.

#### • KEY NOT Programmed:

In case a dull beep sounds, that indicates that the key is **NOT** programmed on the controller.

#### • KEY NOT Recognised:

In case **NO** beep sounds, that indicates that the Key is **NOT** recognised by the controller or external reader.

Check panel thickness and material used. Present **KEY** to the controller or external reader from inside, to rule out panel issues.

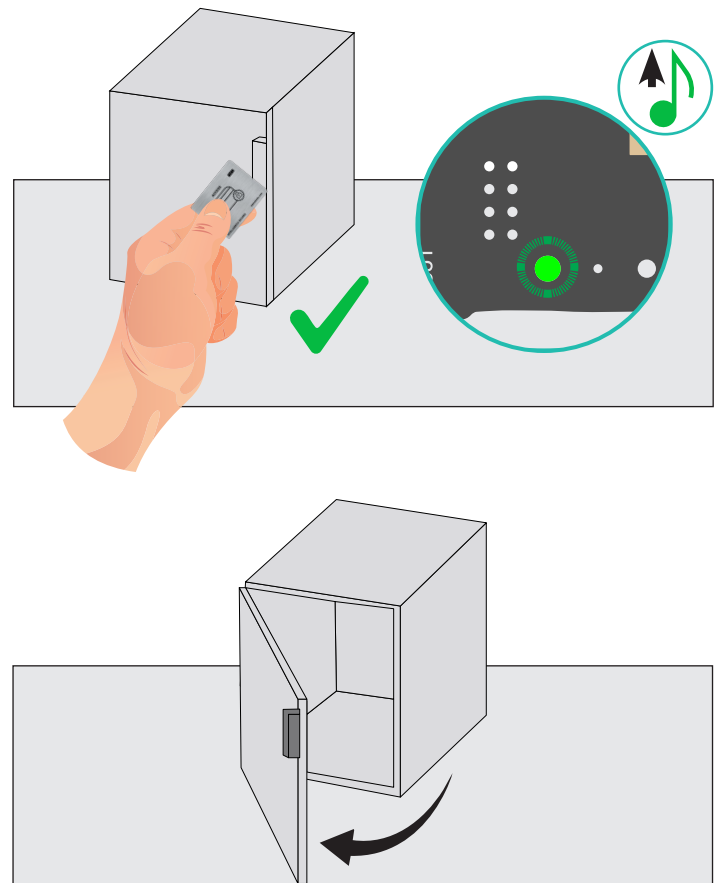

## TEST BEFORE FIXING THE LATCH

Before installing the latch check the system functionality and lock operation.

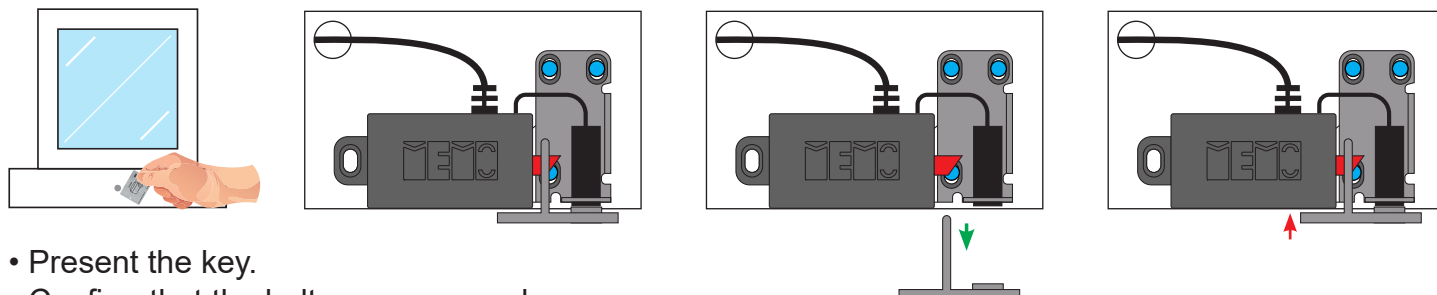

- Present the key.
- Confirm that the bolt moves properly.
- If everything works, install the latch.



### IMPORTANT:

Check system function and lock operation **BEFORE** latch fixation!

## Latch Adjustment

If the key is being read correctly and the lock bolt is moving properly, install the latch on the door or drawer.

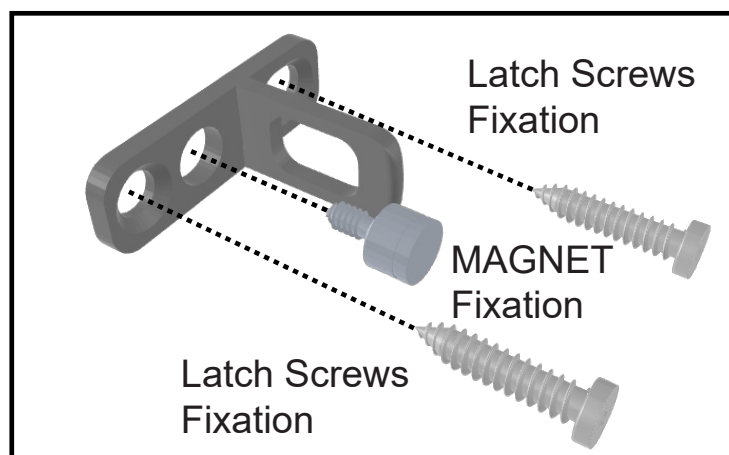

**Latch - Lock  
Incorrect Alignment**

**Latch too high  
Lock Bolt stuck**

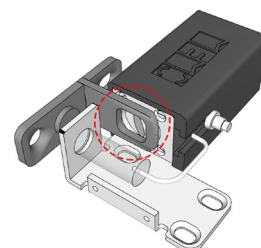
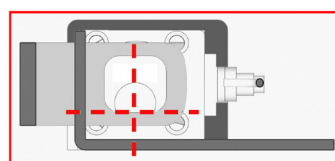

If the latch is not centered, adjust this position until proper alignment is achieved.

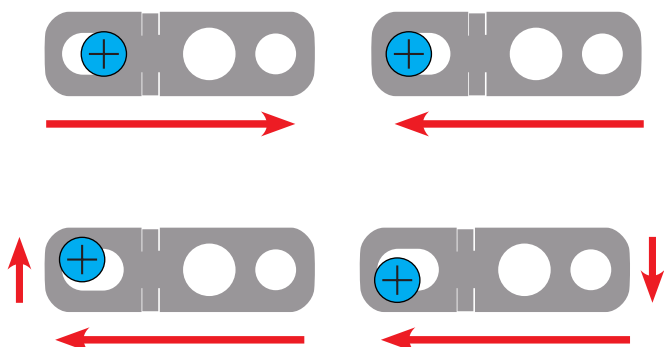

**Latch - Lock  
Correct Alignment**

**Latch  
Centered Position**

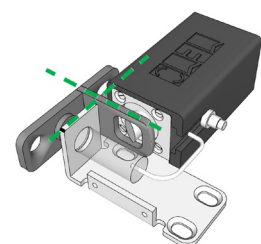
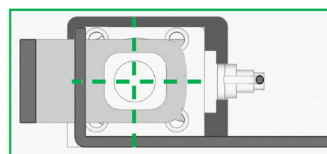

## Lock Adjustment

If the lock is too far inside the cabinet, reposition in to ensure proper alignment.

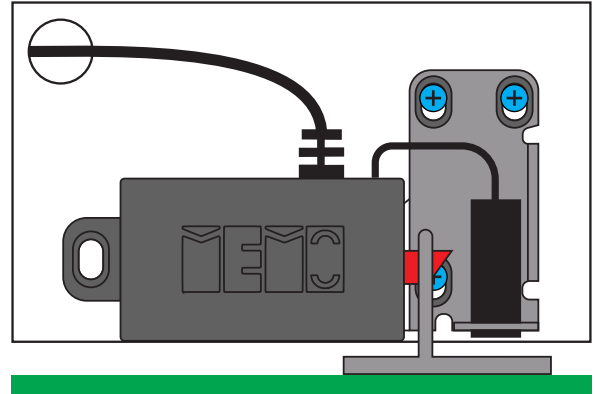
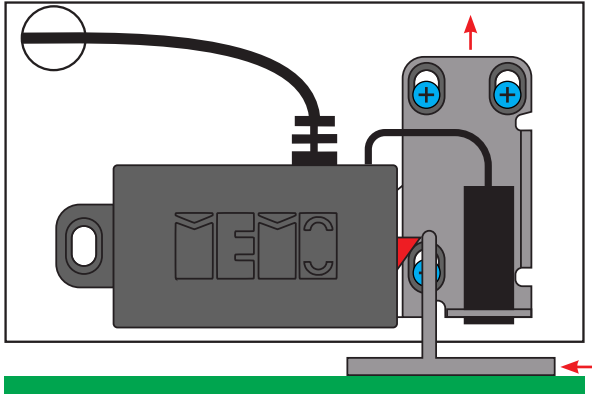

The adjustment is complete when the lock bolt aligns perfectly with the latch. If so, the lock can be fixed in place. Once proper alignment between the lock and latch is achieved, secure the remaining screws and the magnet in the correct position.

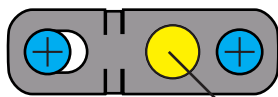

magnet

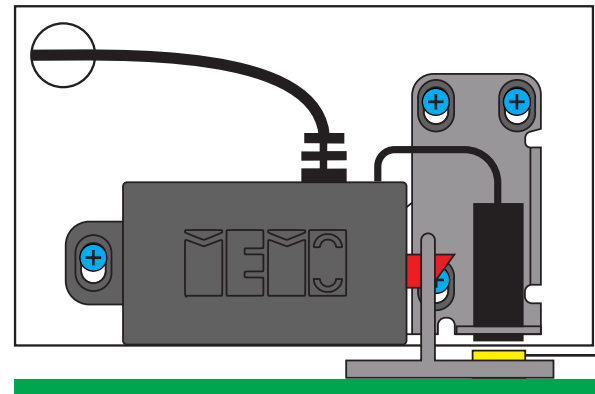

magnet



### IMPORTANT:

When adjustment are insufficient use MEMO shims for lock and latch to ensure proper alignment.







Test the door. Free movement to make sure everything is working smoothly the lock does not have holding spring, so the door may pop open when unlocked.

In this case, an additional holder will be required after installation.

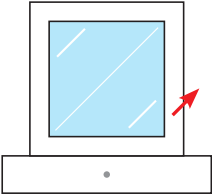
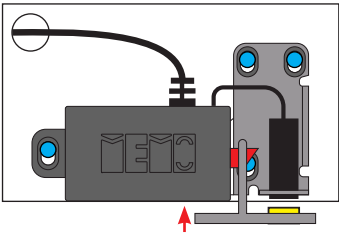
## Test the system

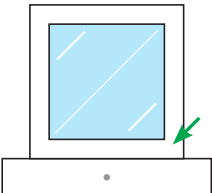
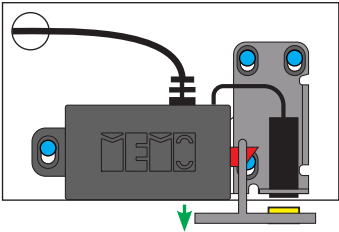
Always pull the door to open and push it to close, ensuring it is securely shut. And remember, always push inwards to ensure proper bolt engagement.

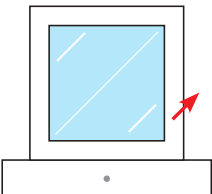
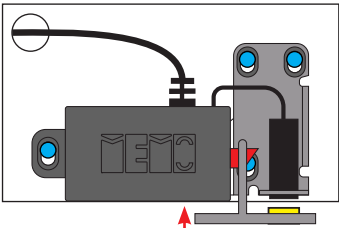
**CORRECT DOOR CLOSING.** Perform a push and pull test on the door to ensure it's fully locked.

			<b>1. PUSH INSIDE to CLOSE</b>
			<b>2. PULL OUTSIDE to CHECK</b>
			<b>3. PUSH INSIDE to REMOVE TENSION</b>

**Perform this PUSH-PULL-PUSH closing EVERY time you close a door and drawer!**