



MEMO AIR2 – Product Family

Electronic Locking & Security for High-End Retail Showcases,
Room-Doors & Storage-Space.



Who is MEMO?

Established in 1986, MEMO has accumulated a wealth of expertise in electronic locking solutions, making us to go-to choose for ensuring security in the world of high-end luxury retail interior.

While you might not be familiar with the name “MEMO” off the top of your head, it’s highly probable that you’ve stepped into a luxury retail store where our cuttingedge security systems are quietly at work, ensuring your safety and peace of mind.

Why Electronic System?

Traditional keys pose ongoing security risks when lost, often requiring multiple keys for various showcases.

In contrast, electronic locking provides an elegant solution, using a single electronic key for multiple access points. Electronic locks are more durable.

The MEMO App streamlines keys management, swiftly deactivating lost keys.



MEMO's AIR2 – Controller Family

Take Control of Your Furniture's Security, over AIR - Manually or through the MEMO APP in APPLE and ANDROID shop!

AIR2ONE Integrated Reader



AIR2MINI External Reader



NEW AIR2FOUR



AIR2ONE

Introducing AIR2ONE, a compact furniture security controller with INTEGRATED reader, perfect for stand-alone showcases and small to medium-sized boutiques. This integrated design streamlines installation, reducing components and space requirements.

The MEMO App simplifies key management and card configurations, providing fast access and biometric authentication.

The Air2 product family offers a cost-effective solution, with optional security features available through flexible Optional plans.

App Control

Clear Sound

Bluetooth & WIFI

Visual and Acoustic
Signals

High Performance
Locks

Coded & Clicking
Connectors



1. AIR2ONE Controller
Internal Reader



2. Lock Type 0002



3. Power Supply

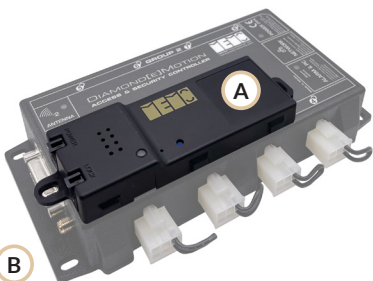
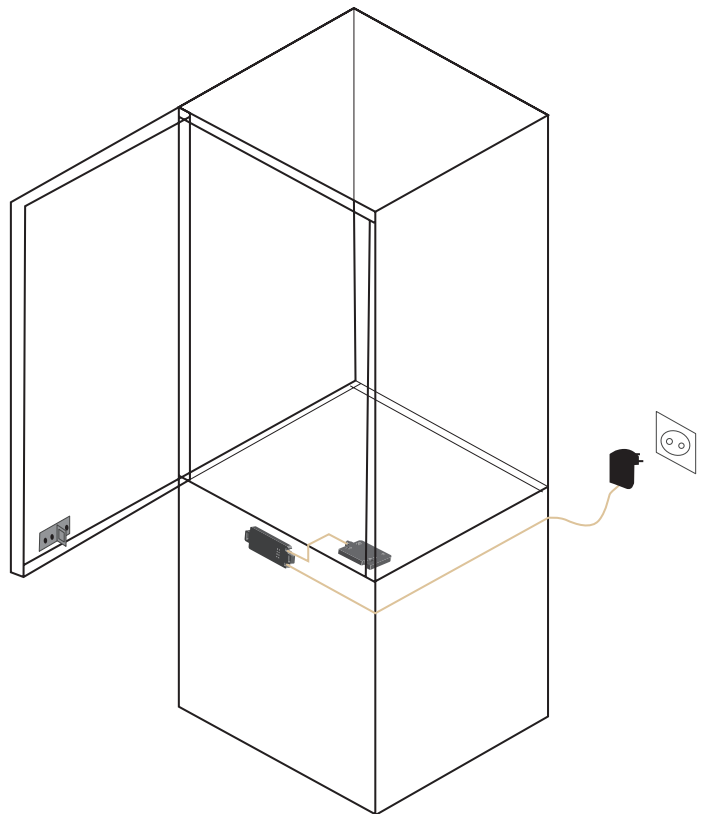

A) AIR2ONE Controller: "A new dimension in size and performance"

B) DIAMOND[E]MOTION - Controller

Controller with INTEGRATED Reader and SIMPLE Connections

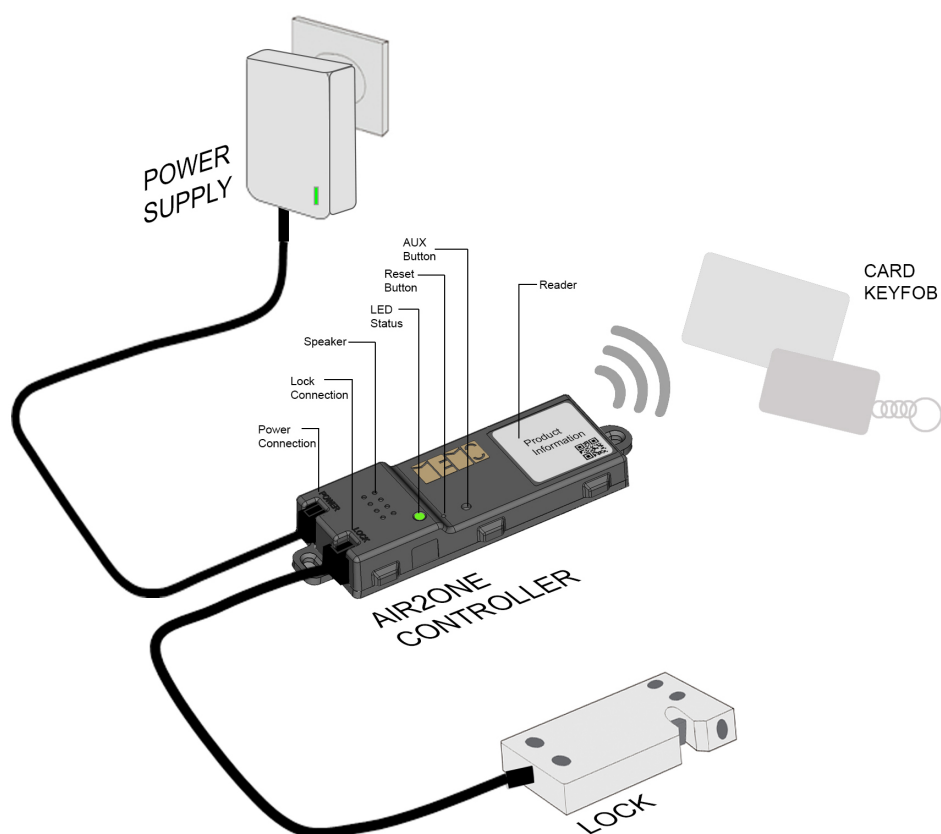
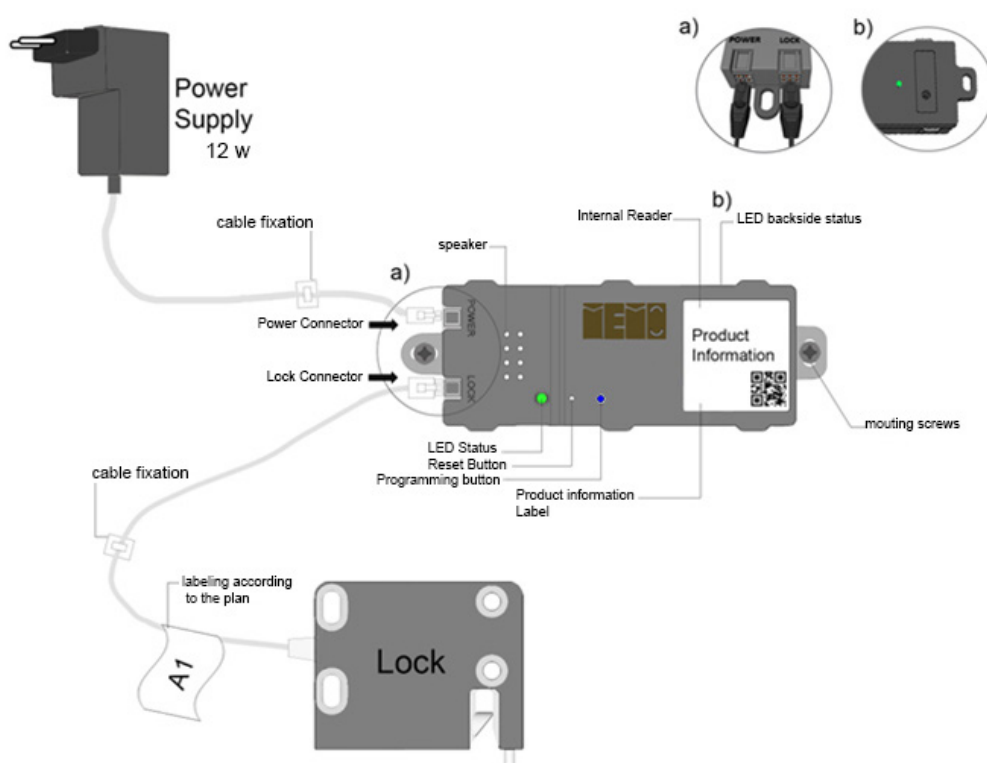

Controller AIR2MINI and Connections

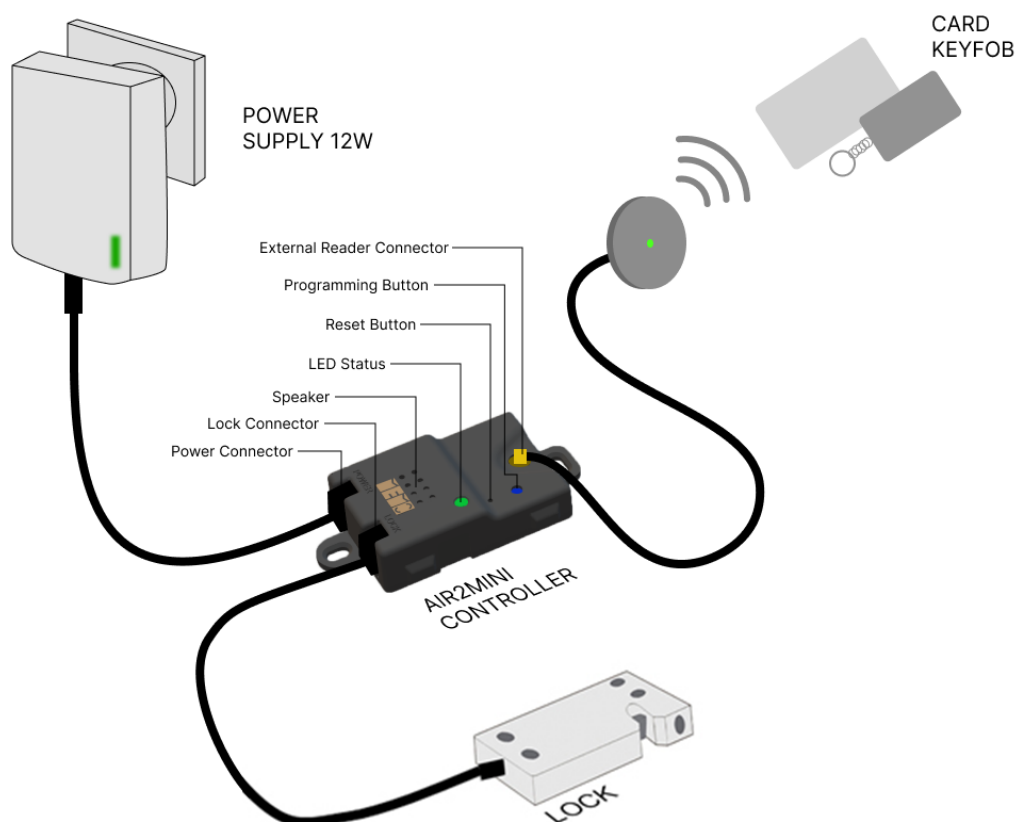
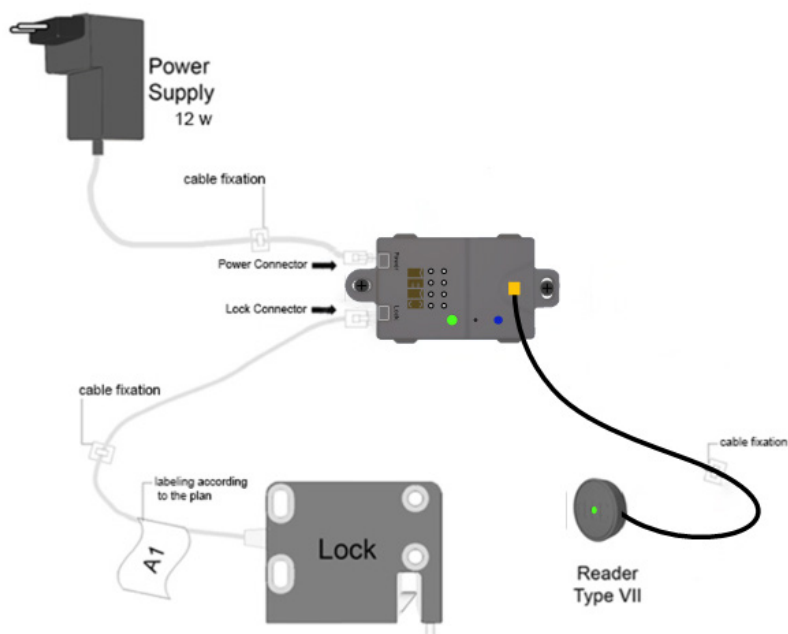

Controller AIR2FOUR and Connections

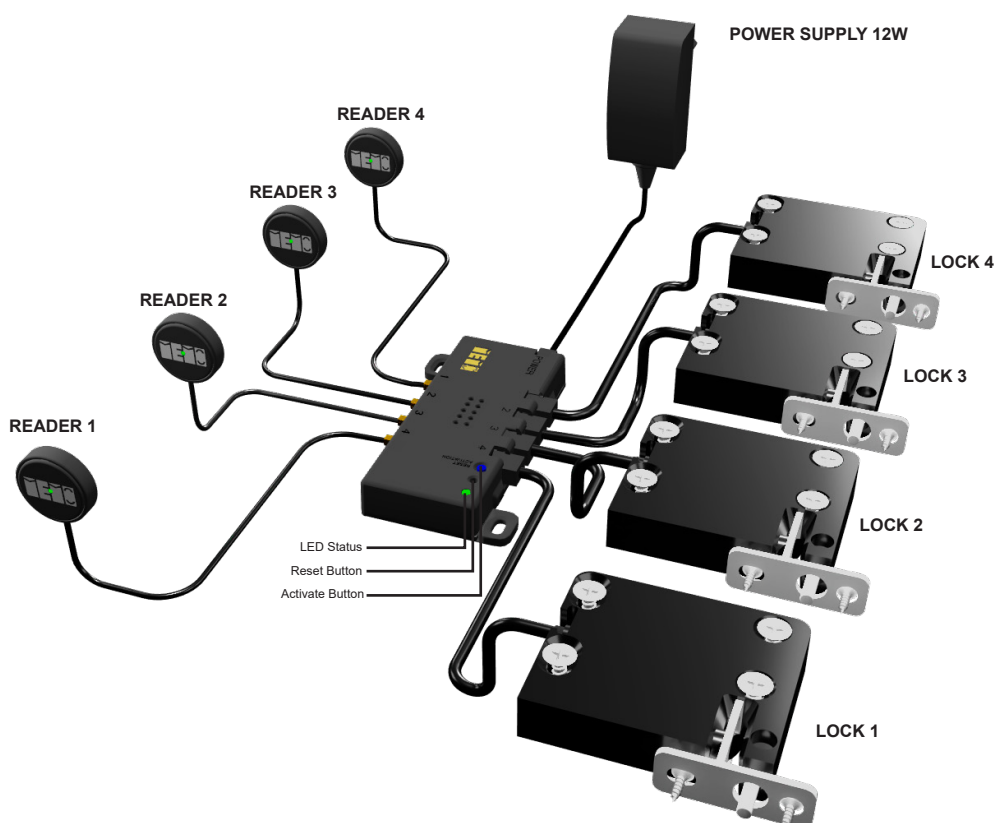
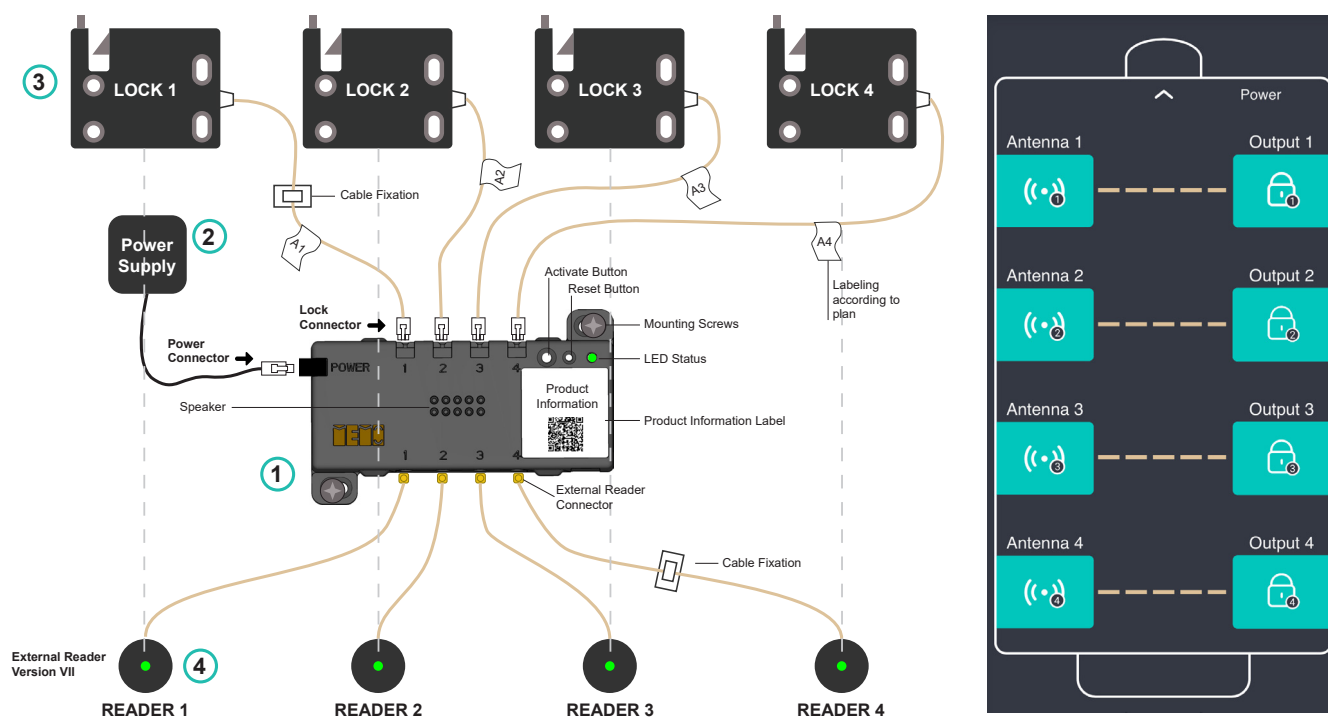

Mounting Recommendations

AIR2ONE Controller Internal Reader version

The controller is directly mounted at the BATCH-POINT inside the panel. This is reducing the amount of:

- Components
- Cables
- Preparation in the Show Case
- Installation time
- Chances to make mistakes
- Final System Costs

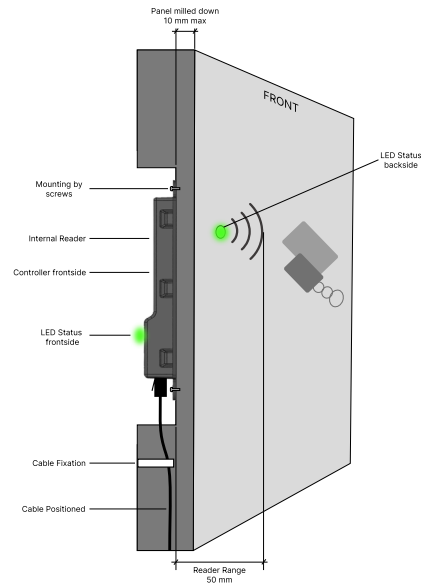

AIR2ONE Controller External Reader and AIR2MINI Controller

The controller is conveniently mounted inside the Show Case.

Reader can be positioned conveniently at the perfect batching position.

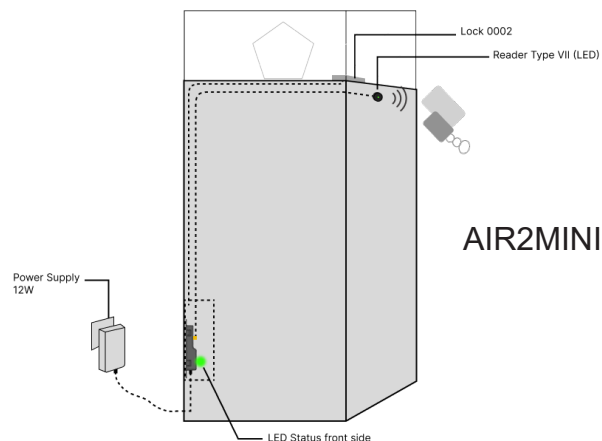

AIR2ONE

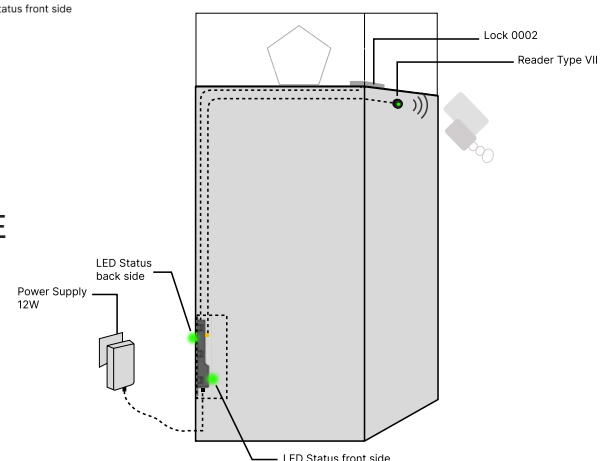

AIR2FOUR configuration examples

Scenario

4 pcs Stand Alone Showcases: Assignment 1 Reader - 1 lock

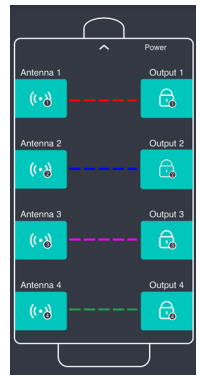
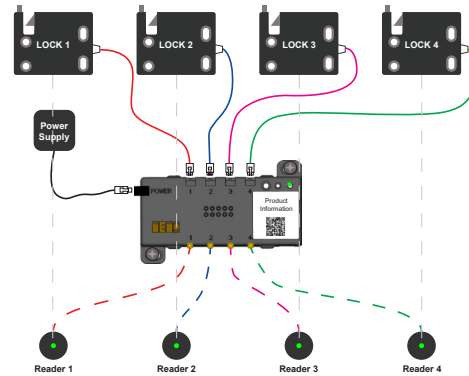
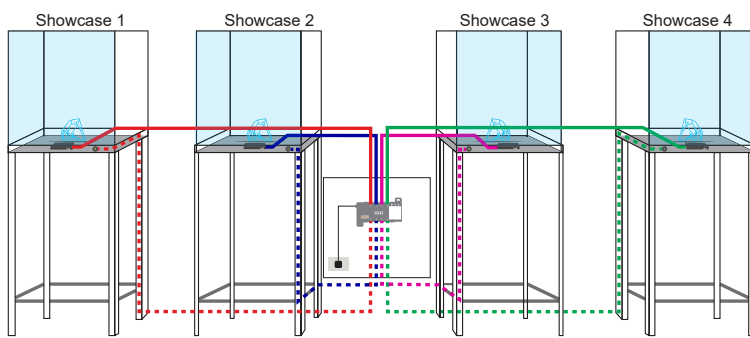

Scenario

2 pairs of opposite showcases: Assignment 2 x 1 Reader - 2 Locks

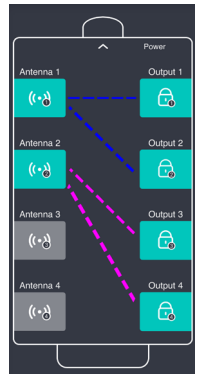
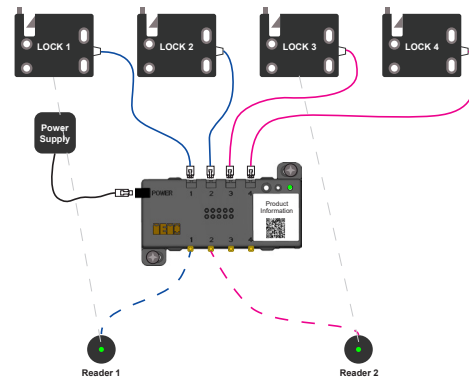
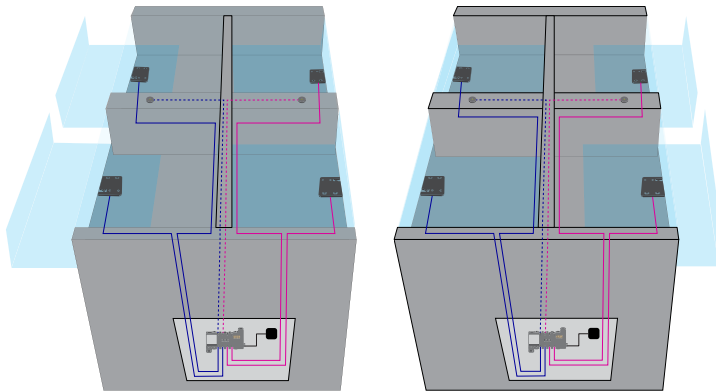

Scenario

1 Security Room Door Assignment: 2 Readers - 1 Lock

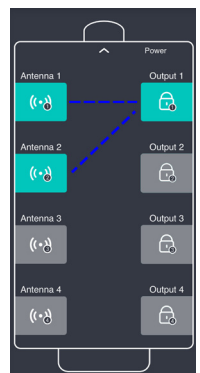
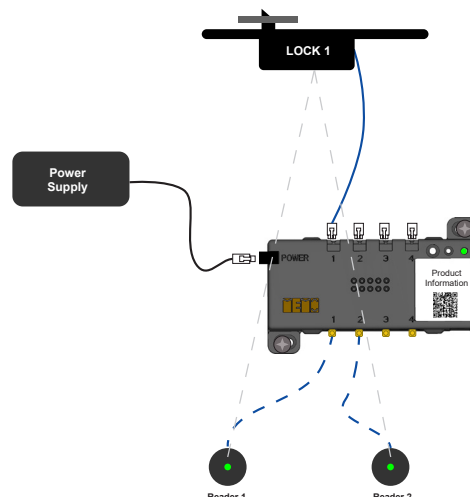
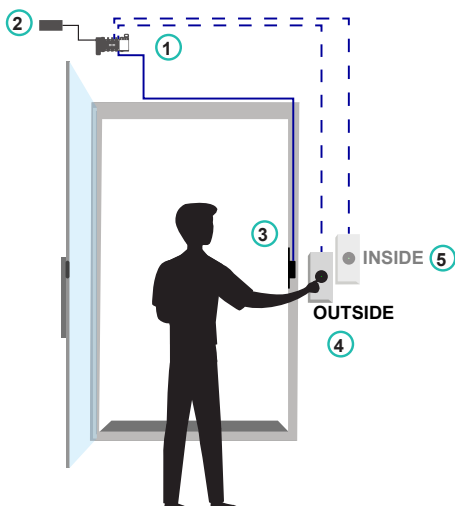

AIR2-LINE – Chip Key Types

Manage Keys and Features of your AIR2-Family via Integrated or External Reader.



Access Key Fob

Presenting the Access Key fob at the AIR2-LINE Internal Reader / External Reader allows to open the showcase.

Access keys are neutral at delivery and must be programmed following the described procedures in this document. Lost or stolen Chip Keys must be reported to the management to avoid possible misuse!



System Card

Identify the system owner; they are required for all administrative operations such as setting changes or key programming. Store the system Card carefully, lost or stolen cards are a serious security leak and must be deleted immediately!

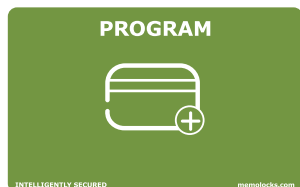

Program Card

Is used for convenient programming of Access Key fobs via AIR2-LINE Internal Reader / External Reader.



Erase Card

Is used to ERASE ALL keys in one go conveniently through the Internal Reader or External Reader! After erasing Keys must be programmed again to resume normal operation!

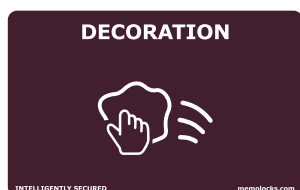

Decoration Card

Allows convenient show case decoration without Warning Sounds and Door Open Limitations. MEMO recommends use of this card only outside normal shop opening times. Access to this cards should be granted only to authorized decoration staff.
(Optional Feature)

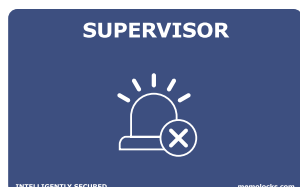

Supervisor Card

Are used by the Shop Supervisor to stop Intrusion Alarms.
(Optional Feature)

Prepare an AIR2-LINE Consignment in the WORKSHOP

Prepare a number of controllers for a project as long as they are easily accessible. Prepare a set of SYSTEM CARD + SPECIAL FUNCTION CARDS + ACCESS KEYS That shall be programmed in the batch of controller.

EVERY AIR2ONE Controller must be programmed with a SYSTEM CARD + SPECIAL FUNCTION Cards BEFORE the installation in a show case. ALLE Karten und Schlüssel MÜSSEN an den KUNDEN übergeben werden.

1. Connect CONTROLLER to the Power and wait until beep sounds.

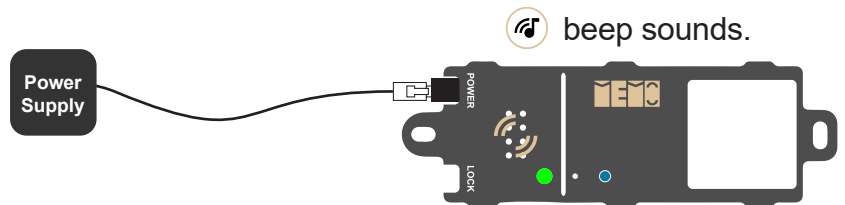

2. Press ACTIVATE button and watch for the LED to start GREEN blinking. (AIR2-LINE must be connected to the Power)

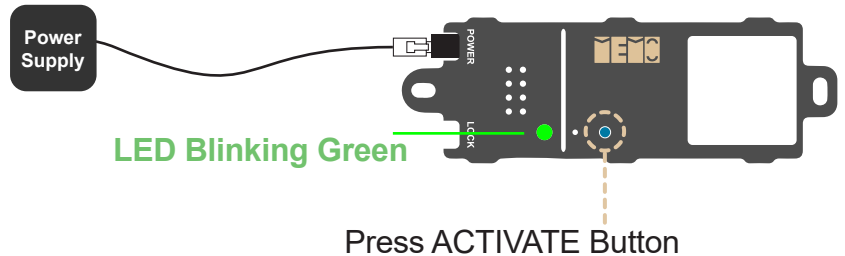

3. Present All Cards, Special Function Cards and Key fobs One-by-One at the CONTROLLER (Internal Reader version) or at the External Reader in a timely distance of max. 2 seconds.

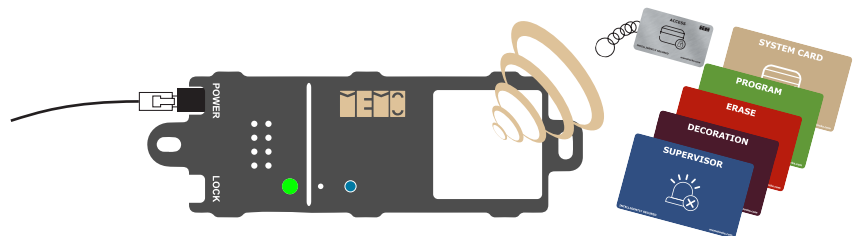

After last key/card was presented, watch out for the significant 3-tone reboot-sound.

LED Stops Blinking GREEN, signaling that the AIR2ONE is ready.

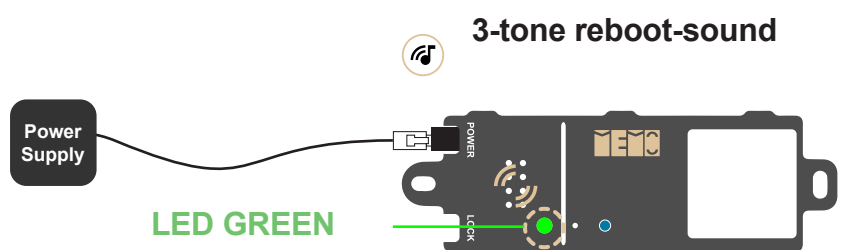

Repeat the same process from STEP 1 for all the controllers.

AIR2-LINE Key & Setting Management at the SHOWCASE

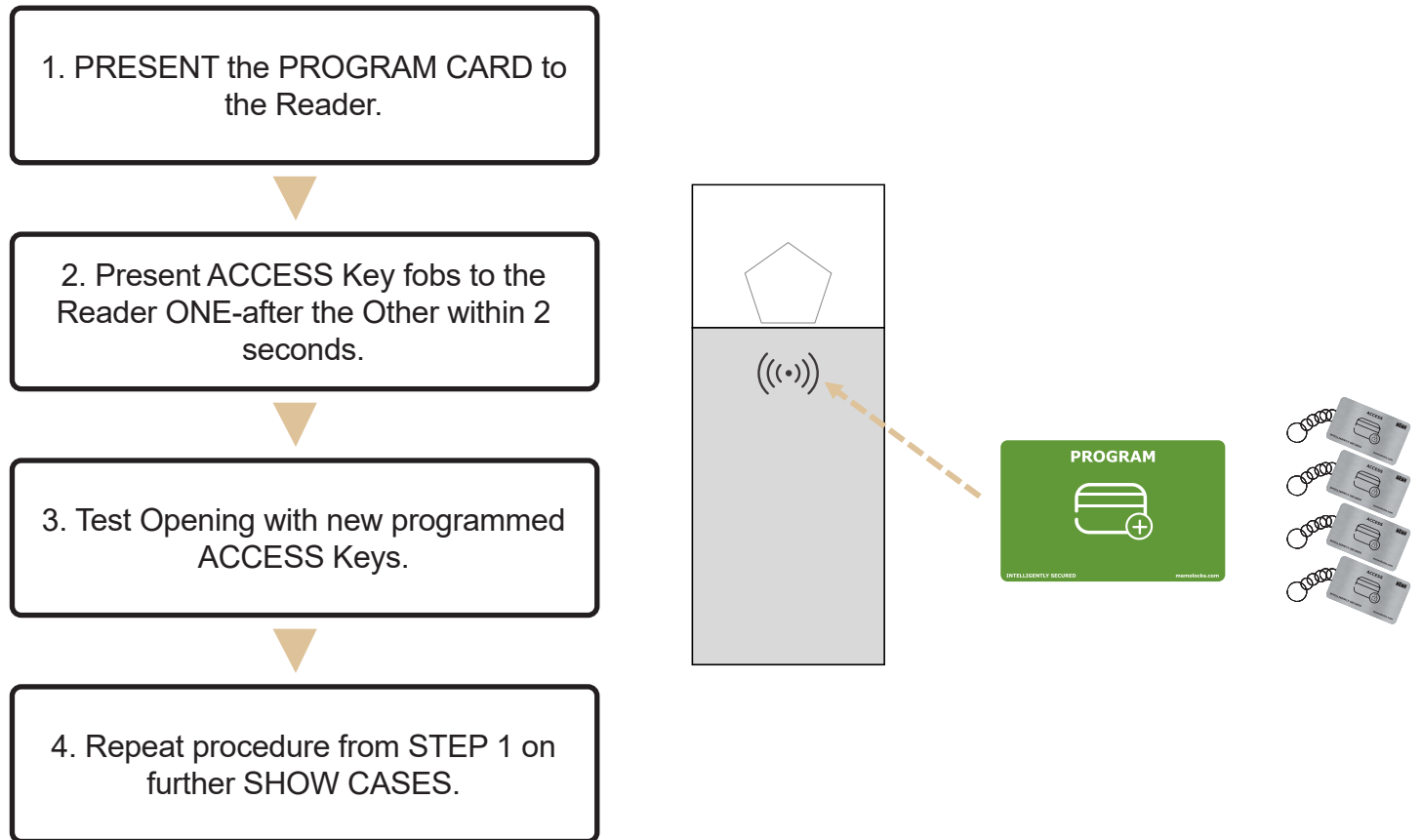

***Access Key fobs can be programmed for individual access to the different controllers ! In case of multi-brands projects.**

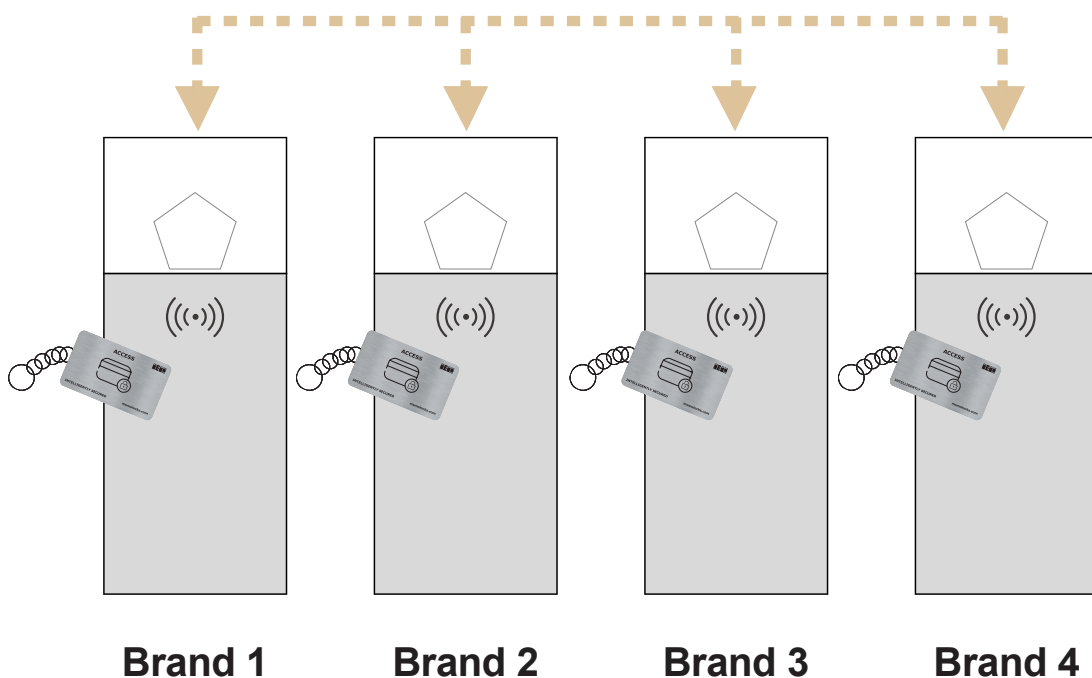

Manage a LOST KEY at the SHOW CASE

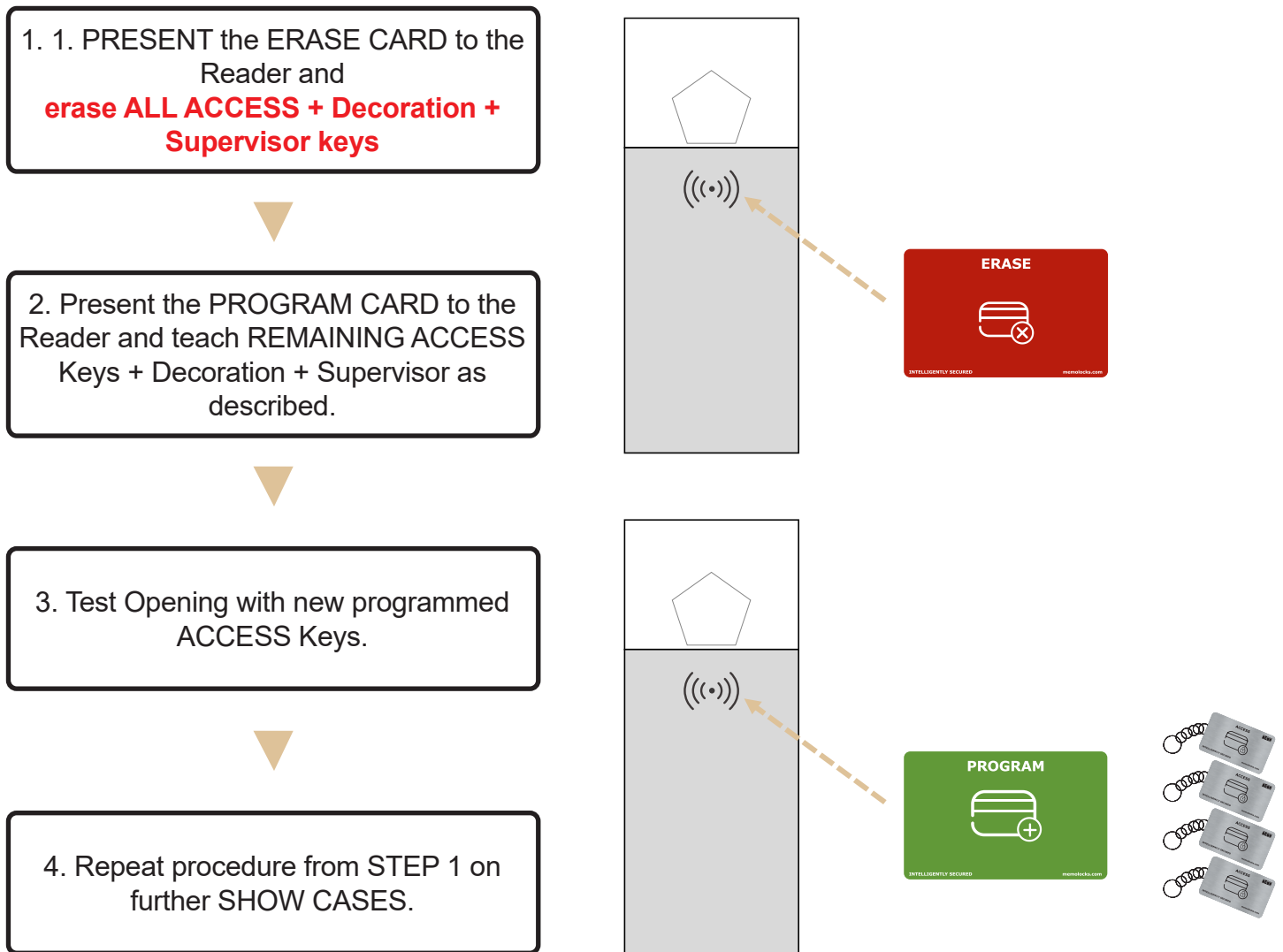

Be AWARE that ALL ACCESS KEYS and SPECIAL FUNCTION CARDS are erased in ONE step – after this procedure, it will be impossible to open the lock of this controller!

To open the show case, new Keys and Cards must be programmed according to one of the before described procedures!

Teach & Replace PROGRAM & ERASE CARDS at the SHOW CASE.

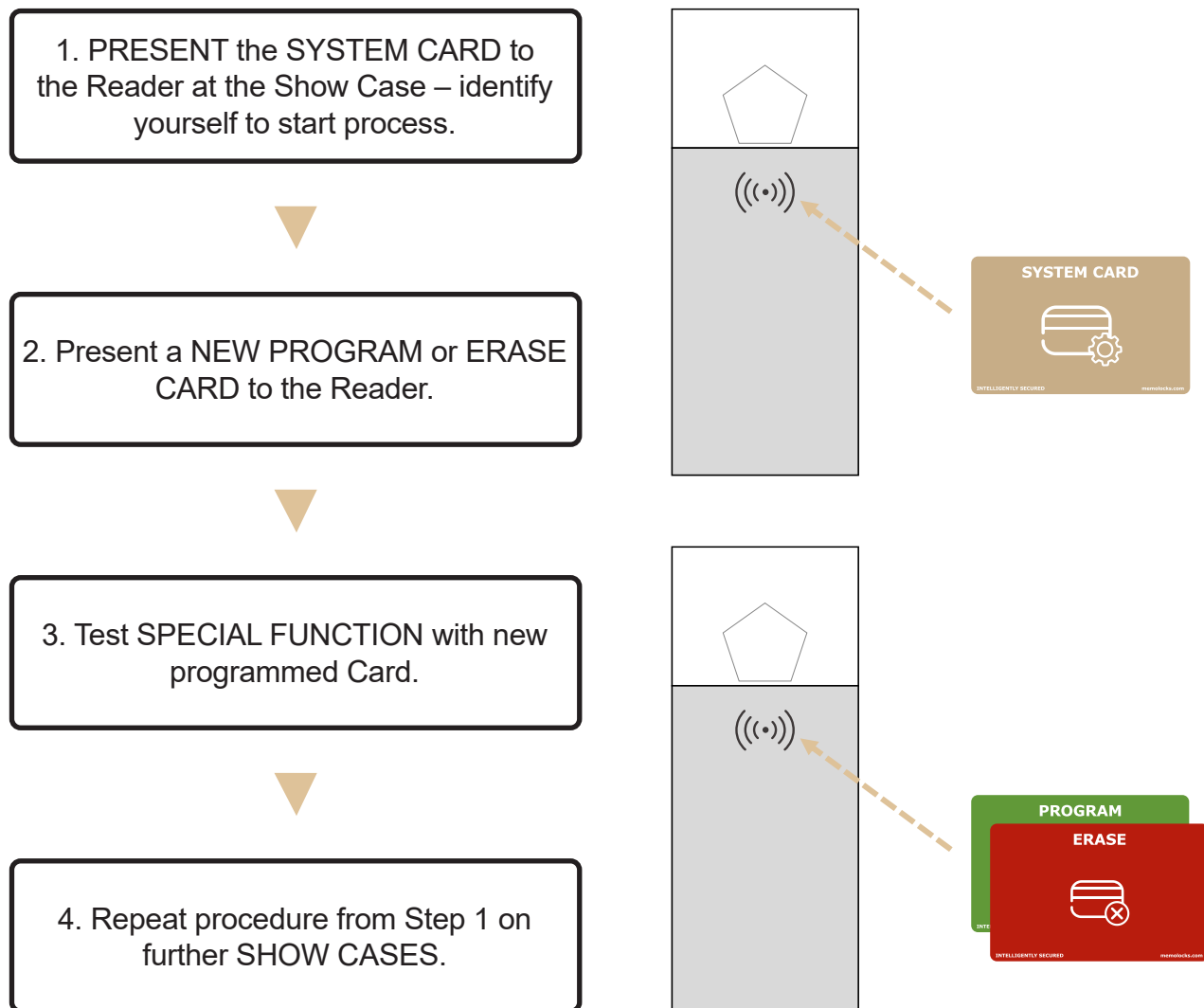

***Old SPECIAL FUNCTION CARD will be replaced by new Card because only 1 of each can be programmed for each Controller.**

Teach and Replace DECORATION & SUPERVISOR CARD at the SHOW CASE.

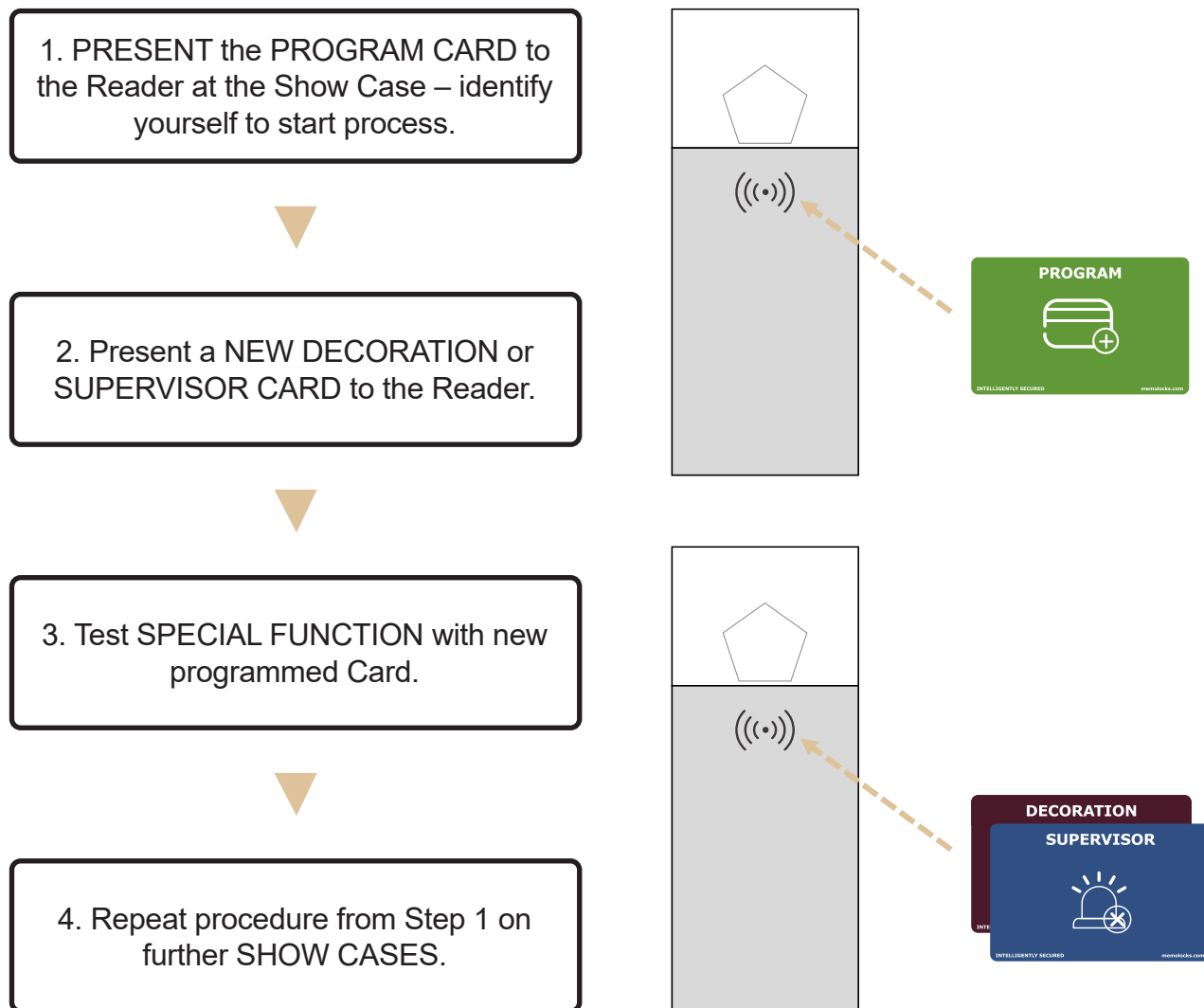

***DECORATION & SUPERVISOR CARD(s) will be programmed additional to the existing cards since they are part of the 300 User-Cards which can be managed by each Controller.**

In case a DECORATION or SUPERVISOR CARD(s) got lost or stolen, they MUST be ERASED as described in “ERASE-Procedure” to avoid any SECURITY LEAK!

Manage SPECIAL FUNCTION CARD at the SHOW CASE

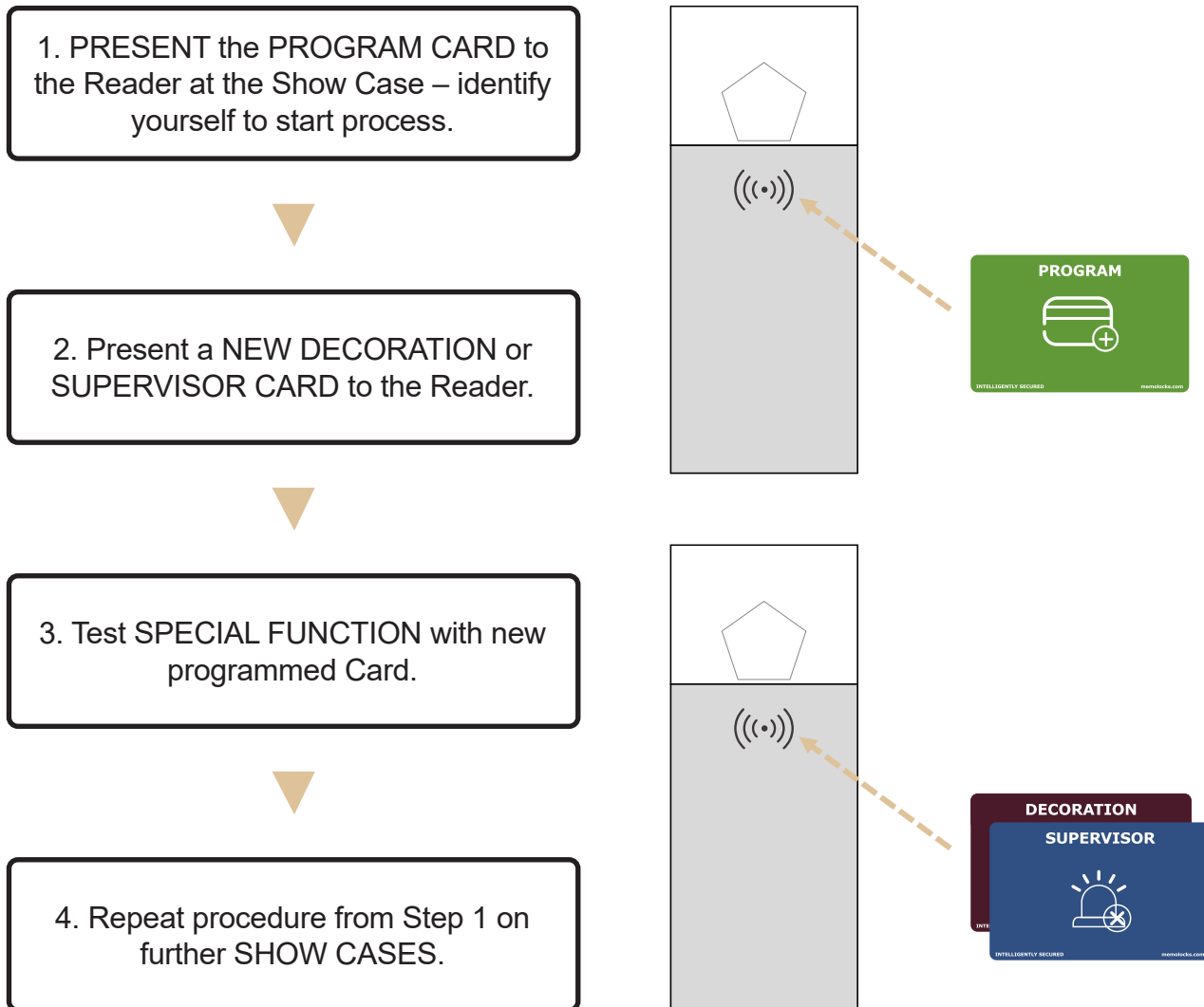

***DECORATION & SUPERVISOR CARD(s) will be programmed additional to the existing cards since they are part of the 300 User-Cards which can be managed by each Controller.**

In case a DECORATION or SUPERVISOR CARD(s) got lost or stolen, they MUST be ERASED as described in “ERASE-Procedure” to avoid any SECURITY LEAK!



AIR20NE - Memo-Lock APP

Download app

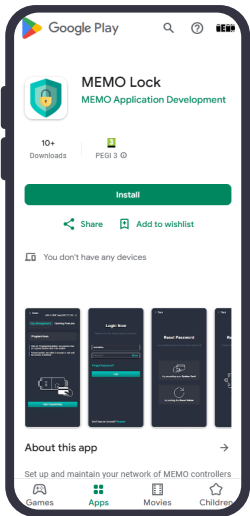

For Android Phones (Play Store)

Step 1: Open the GOOGLE PLAY STORE

Step 2: Search for the “MemoLock” App

Step 3: Select “MemoLock” and tap “INSTALL”

Step 4: Wait until Download is ready

Step 5: Tap “Open” to start “MemoLock”

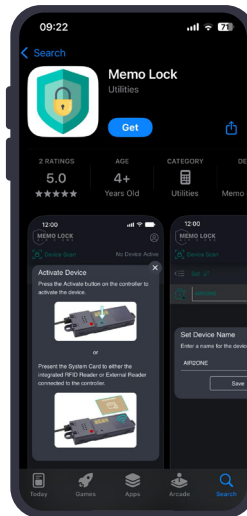

For iPhones (Apple Store)

Step 1: Open the Apple Store App

Step 2: Search for the “MemoLock” App

Step 3: Select “MemoLock” and tap “Cloud-Symbol” to install

Tip: If prompted, confirm the installation by using your iCloud password, Face ID, or Touch ID (depending on your phone).

Step 4: Wait until Download is ready

Step 5: Tap “Open” to start “MemoLock”

How to Get Started

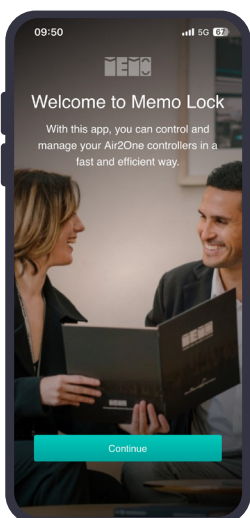

1. Welcome Screen

Introduction, “Continue” to next screen

2. Change Features Screen

Info about flexible configuration, tap “Continue”

3. Convenient Control Screen

Info about Key-Management, tap “Continue”

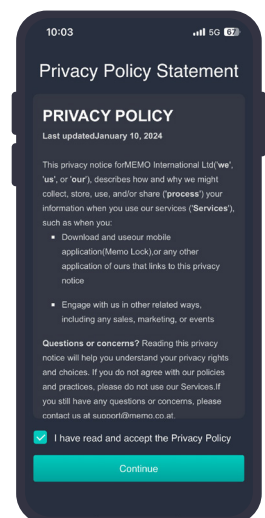
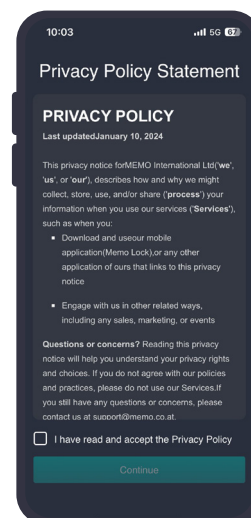

4. Privacy Policy Screen

Read carefully, confirm acceptance and tap “Continue”

AIR20NE - Memo-Lock APP

Login Screen

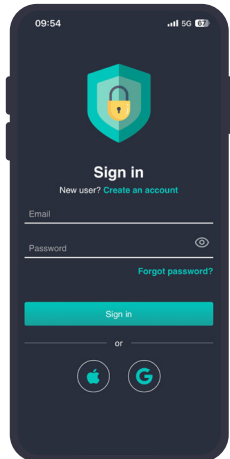

Login with your Account details:

1. Enter User Name & Password, then tap "Sign In"
2. Alternatively you can use your Google/ Apple account details, click the symbol

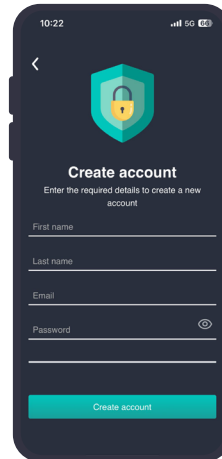

Sign-Up Screen

Create your USER ACCOUNT when this is your first landing.

1. Enter your details, including a valid email address
2. Choose your User Password
3. Tap the "Create Account" button

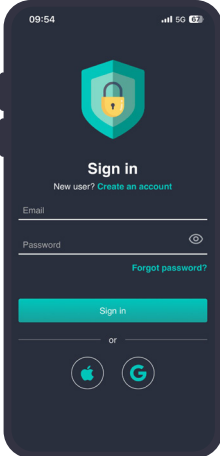
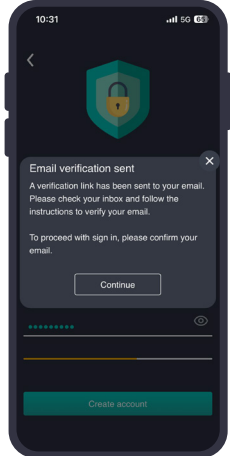

Verification Screen

A verification email will be sent.

1. Open your Inbox
2. Open the Verification Email
3. Click the "verification" link
4. Return to the Mobile App and click "continue"

Scanning for Devices Screen

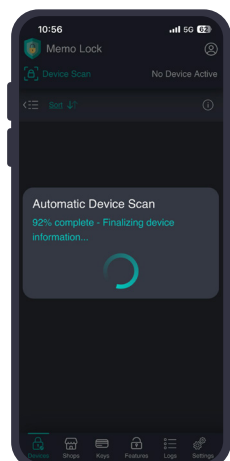

At every login, the app will scan for devices in range

1. Wait until scan operation is finished

2. Device Scan Results Screen

All MEMO Devices in reading distance will be shown in a list, tap "close"

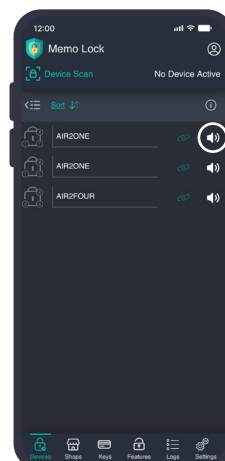

Identify Device
- Click on the 'Identify' button to locate the device using audio produced by the device, and LED blinking white.

Devices Screen

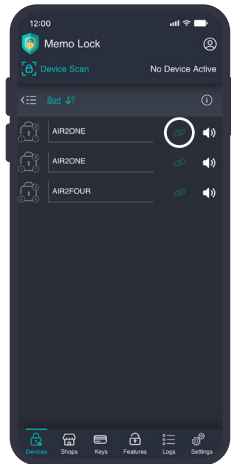

All scanned controllers are shown in a list.



Activate Device

- Click on the 'Connect' icon to start activation process with the device.

For each activation process, you have a 30 second time limit to activate the device. If the time expires, you will be shown a message telling you to try again.

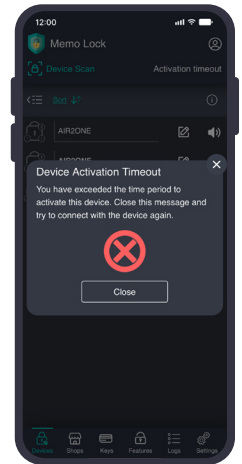

Activating the Device

When activating your device, there are two options available. Here's how to proceed:

Option 1: Activating with the Blue Button

a) Activate device by pressing ACTIVATE button. (When AIR2ONE is easily accessible)

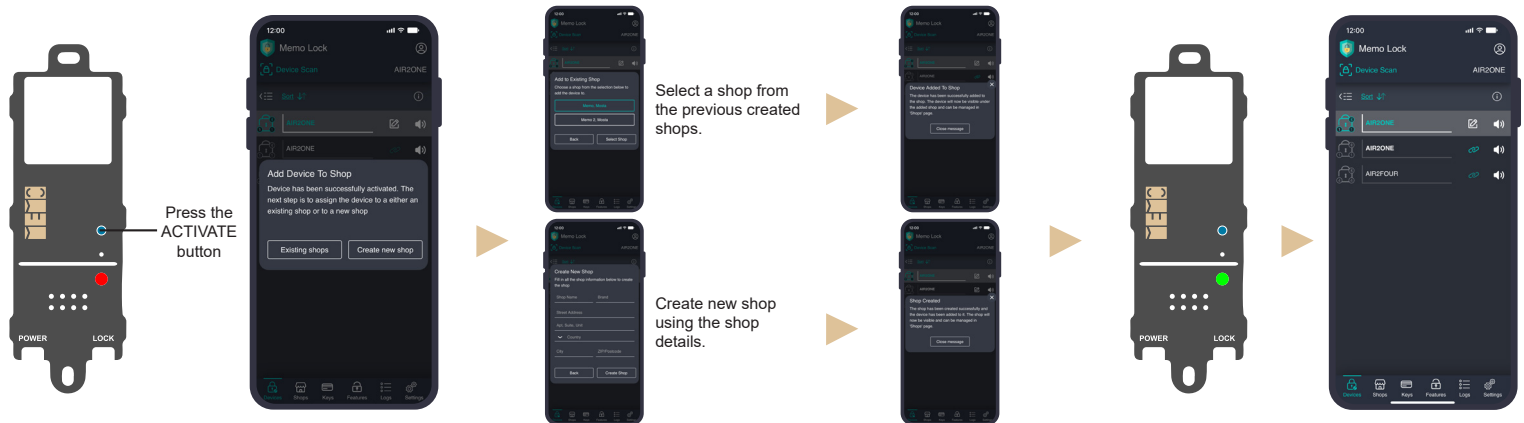

When Activated, the device will be shown as Active, and the device name will show up in the top right corner.

Option 2: Activating with the System Card (Gold)

4b) Alternatively present the SYSTEM CARD at the BATCH POINT. (When AIR2-LINE is inaccessible inside the furniture)

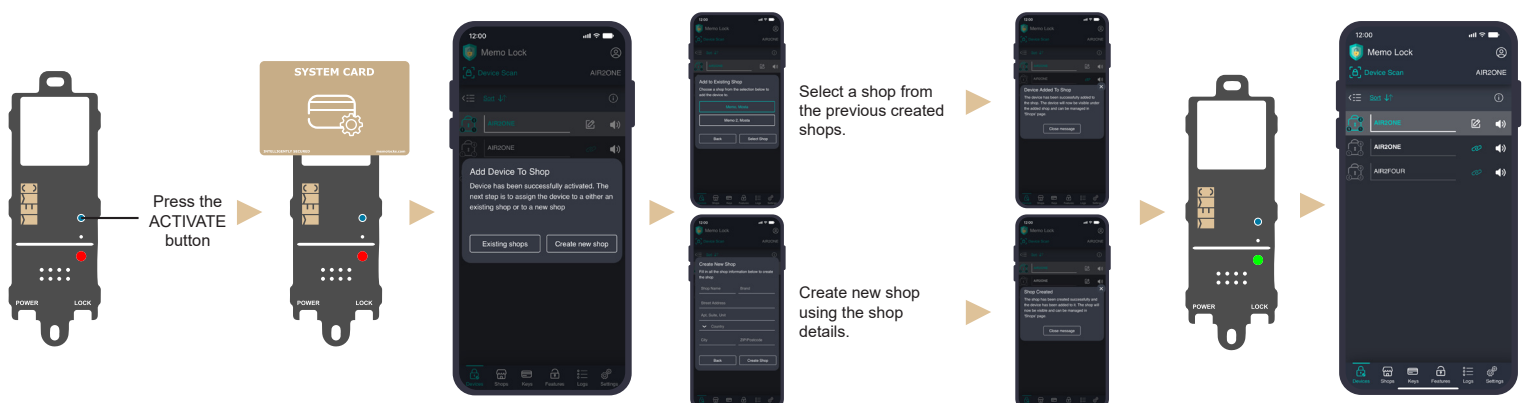

When Activated, the device will be shown as Active, and the device name will show up in the top right corner.

AIR2ONE - Tutorial



SCAN ME

Video Tutorial – Create Account and Activate Device

The video is showing the navigation of the user when the app is opened, account is created and the device-activation.



SCAN ME

Video Tutorial – PROGRAM Keys

This is a video tutorial showing the process of programming new cards/keys to your controller.



SCAN ME

Video Tutorial – ERASE Keys

This is a video tutorial showing the process of erasing cards/keys from your controller



SCAN ME

AIR2-LINE Set Up by MEMO SUPPORT MEMO Cloud Services (*Optional Feature)

Your AIR2-LINE System provides innovative functions over MEMO Cloud Services on subscription base..

Contact MEMO sales team and experience the powerful options of MEMO Data Services.

AIR2ONE Free Features

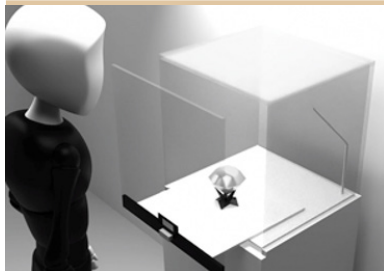

OPENING TIME

The duration in seconds which the door will remain open after an authorized key presentation. After the time passes, the lock will be activated automatically, both when the door is opened or closed.



WATCHMAKER MODE

Presenting an authorized ACCESS key to the batch point unlocks the door and the door stays open for indefinite time. At next presentation of an ACCESS KEY, the lock will close and stays closed.

This mode is used for WATCHMAKER desks, managers office furniture, storage cabinet etc.



VALIDATION MODE

Before starting a workday, the ACCESS KEY must be validated in the shop at VALIDATION UNIT. Keys remain active for typically one workshift, after that, keys will become inactive and require validation for next shift.



OPEN DOOR WARNING**

Doors and drawers should not remain open longer than necessary to reduce the risk of criminal theft. The "OPEN DOOR WARNING" sound reminds you when a show case is open longer than it should.

AIR2-LINE Subscription Package

MEMO SUBSCRIPTION PACKAGES tailors the perfect Solution for your SECURITY & CONVENIENCE POLICY - you pay only per Controller / Feature for the combination you need.



OPTIONAL FEATURES

Increase the security in your shop and make it less attractive for criminal threats.



ADVANCE MAINTENANCE WARNINGS

Informs you in the moment when a Show Case can not lock properly – even earlier than your staff will recognize.



MEMO MARKETING STATISTIC

Provides you solid Information about Sales Activities, Staff Efforts, Shop Effectiveness and much more.



MESH BLE NETWORK SERVICE SUBSCRIPTION

Enables system management in one operation for all controllers. MEMO network components and configuration service is required.



WARRANTY

As long as the SUBSCRIPTION PACKAGE is active – max. 15 years.

AIR2-LINE Optional Features



SECURITY MODE & WARRANTY

Presenting an authorized ACCESS KEY to the batch point unlocks the door and the door can be opened during that preselected time (5s). This mode deactivates the lock IMMEDIATELY when the door is opened.

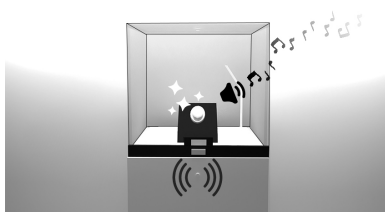

ENHANCED SOUND SET & WARRANTY*

Activates a soft warning sound that starts decent with single beeps to allow sales staff to close without the conversation to be disturbed. Additionally the volume of the warning sound can be adjusted less and higher which provides perfect adjustment to the environmental noise and the show case sound damping.

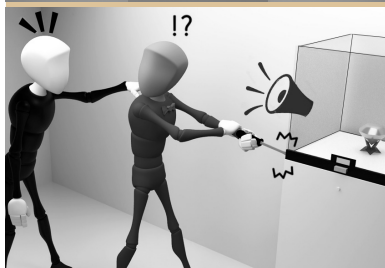

INTRUSION ALARM & WARRANTY

In the moment a door is opened without a legitimate chip key, an alarm will sound out of that display. The supervisor must check the situation and present the SUPERVISOR CARD* to stop the Intrusion Alarm.

*Supervisor Key recommended.

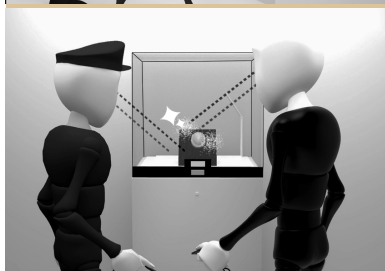

2-WAY AUTHENTICATION & WARRANTY

2 authorized keys must be presented within 5s to activate a lock and open a door. This feature is useful for special products which require special security. 2 personnel can protect special valuable items much better than only one.



OPENING DELAY & WARRANTY

Opening is carried out after a certain predefined period of time. This feature is particularly effective in conjunction with stable showcase constructions to protect very high values.

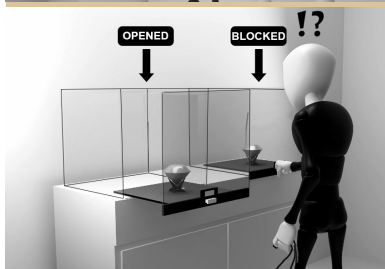

ONE DOOR ONLY & WARRANTY

To reduce the risk of tricky theft in your shop, activate this feature – it allows only ONE door to be open in a show case at the time. To open another door, this one must be closed before.*

* Sound On, Soft Open Door Warning ,volume level adjustable.

AIR2-LINE FAMILY

1.Lock Types

MOTOR LOCK - DOOR SENSOR



MI-MMV1-0002-12HSAIR



MI-MMV1-2002-12HSAIR

b) MAGNETIC LOCKS - DOOR SENSOR



MI-MMV1-0923-12AMAIR



MI-MMV1-1051AIR

c) OWD's



FLAT



ANGLED



VERTICAL

2.Power Supplies



PSY3-0012-12AIR
Power Supplies 12W



PSY5-0040-12AIR
Power Supplies 40W

AIR2ONE Integrated Reader



AIR2MINI



AIR2FOUR

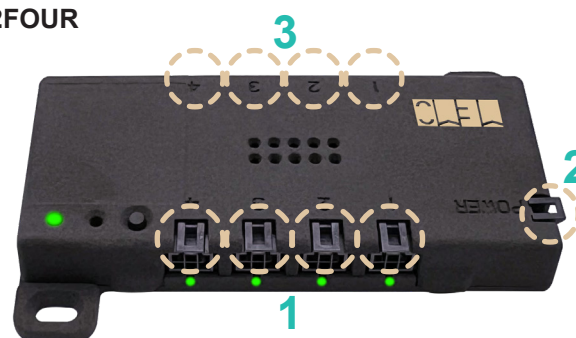

3. External Readers



MI-ANT3-0001-03AIR
Reader Type III



MI-ANT5-0001-03AIR
Reader Type V



MI-ANT7-0000-03AIR
Reader Type VII